

**Hexagon nut
DIN 934 A4**

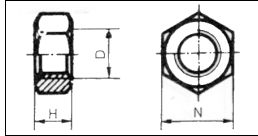

Art.nr.	Dim	Antal
320015	M3	8 st.
320025	M4	8 st.
320031	M5	7 st.
320041	M6	5 st.
320051	M8	3 st.
320061	M10	2 st.
320071	M12	2 st.

Self locking hexagon nut DIN 985 A4

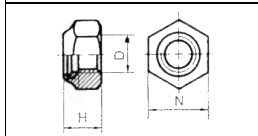

Art.nr.	Dim	Antal
321015	M3	4 st.
321025	M4	2 st.
321035	M5	2 st.
321045	M6	2 st.
321051	M8	2 st.
321061	M10	2 st.
321071	M12	1 st.

**Hexagon domed capnut
DIN 1587 A4**

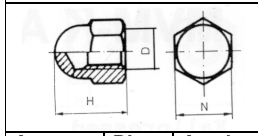

Art.nr.	Dim	Antal
322015	M3	3 st.
322025	M4	2 st.
322035	M5	2 st.
322045	M6	2 st.
322055	M8	2 st.
322061	M10	2 st.
322071	M12	1 st.

**Wing nut, cold pressed
DIN 315 A4**

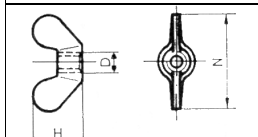

Art.nr.	Dim	Antal
323015	M4	4 st.
323021	M5	3 st.
323031	M6	2 st.
323041	M8	2 st.
323051	M10	2 st.
323061	M12	1 st.

**Washer
DIN 125**

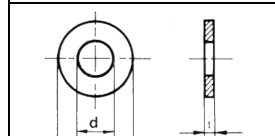

Art.nr.	Dim	Antal
330015	M3	22 st.
330025	M4	20 st.
330035	M5	15 st.
330045	M6	12 st.
330055	M8	7 st.
330065	M10	3 st.
330075	M12	2 st.

**Spring washer
DIN 127 A4**

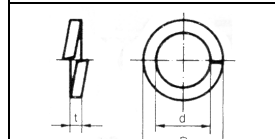

Art.nr.	Dim	Antal
331015	M3	18 st.
331025	M4	18 st.
331035	M5	15 st.
331045	M6	9 st.
331055	M8	7 st.
331065	M10	4 st.
331075	M12	3 st.

**Washer big outer-Diam.
DIN 9021 A4**

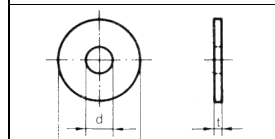

Art.nr.	Dim	Antal
332015	M4	12 st.
332025	M5	12 st.
332035	M6	9 st.
332045	M8	5 st.
332055	M10	3 st.
332065	M12	2 st.

Cup washer nickel-plated brass

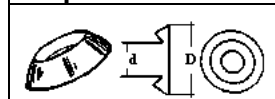

Art.nr.	d	D	Ant.
339015	3,9	9,6	10 st
339025	4,1	11,0	10 st
339035	5,9	14,3	10 st
339045	6,9	15,2	10 st
339055	8,1	16,7	10 st
339065	5,0	13,0	10 st

**Self tapping countersunk (flat) head screw with cross
DIN 7982 A4**

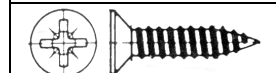

Art.nr.	Ø x L	Antal
314015	2,9x13	20 st.
314035	2,9x19	15 st.
314055	3,5x9,5	12 st.
314085	3,5x13	12 st.
314151	4,2x13	12 st.
314161	4,2x16	12 st.
314241	4,8x19	8 st.
314251	4,8x25	8 st.
314261	4,8x32	6 st.
314271	4,8x38	6 st.

**Self tapping pan-head screw with cross
DIN 7981 A4**

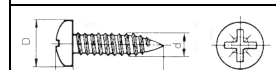

Art.nr.	Ø x L	Antal
311025	2,9x9,5	15 st.
311035	2,9x13	13 st.
311055	2,9x19	12st.
311115	3,5x9,5	12 st.
311125	3,5x13	12 st.
311135	3,5x16	13 st.
311145	3,5x19	11 st.
311155	3,5x25	9 st.
311205	4,2x9,5	12 st.
311215	4,2x13	9 st.
311221	4,2x16	10 st.
311235	4,2x19	9 st.
311241	4,2x25	8 st.
311255	4,2x32	7 st.
311261	4,2x38	6 st.
311301	4,8x13	8 st.
311311	4,8x16	7 st.
311321	4,8x19	6 st.
311331	4,8x25	6 st.
311341	4,8x32	5 st.
311351	4,8x38	5 st.
311361	4,8x50	2 st.
311371	5,5x16	4 st.
311411	5,5x19	5 st.
311421	5,5x25	5 st.
311431	5,5x32	4 st.
311441	5,5x38	3 st.
311451	5,5x50	2 st.

**Self tapping counter-sunk (oval) head screw with cross
DIN 7983 A4**

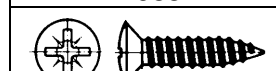

Art.nr.	Ø x L	Antal
507001	2,9x9,5	20 st.
507002	2,9x13	20 st.

**Continuation Self tap-ping countersunk (oval) head with cross
DIN 7983 A4**

Art.nr.	Ø x L	Antal
313105	3,5x9,5	12 st.
507004	3,5x13	12 st.
507005	3,5x16	12 st.
507006	3,5x19	12 st.
507007	3,5x25	12 st.
507008	3,5x32	12 st.
313205	4,2x13	9 st.
313215	4,2x16	9 st.
313225	4,2x19	9 st.
313235	4,2x25	8 st.
313245	4,2x32	7 st.
313255	4,2x38	6 st.
313301	4,8x16	7 st.
507009	4,8x19	8 st.
507010	4,8x25	8 st.
507011	4,8x32	8 st.
507012	4,8x38	6 st.
313361	4,8x50	2 st.
313391	5,5x16	5 st.
313401	5,5x19	5 st.
313411	5,5x25	4 st.
313421	5,5x32	4 st.
313431	5,5x38	3 st.
313451	5,5x50	2 st.

**Hexagon head bolt and screw incl. hexagon nut
DIN 933 =L<=70 mm
DIN 931 =L>70 mm**

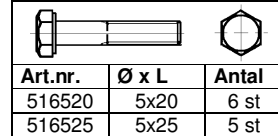

Art.nr.	Ø x L	Antal
516520	5x20	6 st.
516525	5x25	5 st.
516530	5x30	5 st.
516540	5x40	4 st.
300261	6x20	3 st.
516625	6x25	4 st.
300281	6x30	3 st.
516640	6x40	4 st.
300321	6x50	2 st.
516820	8x20	4 st.
300431	8x25	2 st.
516830	8x30	3 st.
300461	8x40	2 st.
516850	8x50	4 st.
516860	8x60	4 st.
300547	8x80	1 st.
300621	10x30	1 st.
517040	10x40	2 st.
300661	10x50	2 st.
517060	10x60	2 st.
300747	10x100	1 st.
300821	12x40	2 st.
300927	12x100	1 st.